

CTM2020

CEILING TUBE MOUNT

A flexible, reliable overhead tube support designed to accommodate all your radiographic requirements.



Durability with Maximum Flexibility



DEL MEDICAL
SYSTEMS GROUP



CEILING TUBE MOUNT SUB SYSTEM SPECIFICATIONS

Product Features

- Servo-linked tube support to wall bucky for accurate alignment
- Servo-linked tube support to table for accurate distance
- Dual release and single release buttons for ease in positioning
- Easy to read digital display readout
- Motorized vertical travel minimizing operator fatigue

Product Specifications

- Longitudinal travel range: 130" (3300mm)
- Transverse travel range: 88.5" (2250 mm)
- Vertical travel range: 59" (1500 mm)
- Vertical tube rotation: +/- 360°
- Horizontal tube rotation: -90°, +180°,
detents at -90°, 0, +90°
- All locks: Electromagnetic
- X-ray tube housing mount: 3" (75 mm) or 4" (100 mm)
- Transverse bridge length: 9'10"
- Longitudinal rail length: 13'2"

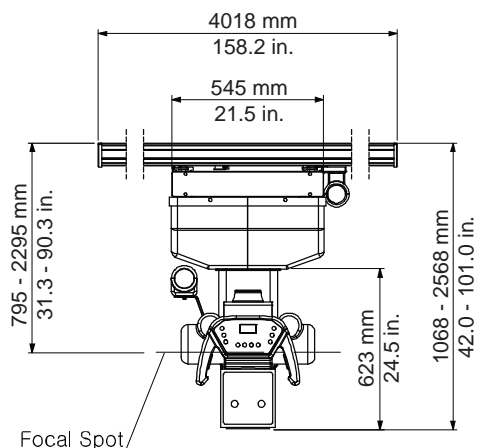

Environmental Specifications

- Electrical connection: 3 conductor with Protective Earth Ground
- Operating temperature range: 41°F~95°F (5°C~35°C)
- Relative humidity range: 10~75%
- Relative pressure: 700 hPa~1060 hPa

Product Options:

- X-ray tube
- Collimator (manual only)
- HV Cables, 60' standard

Weight

- 780 lbs. (354 kg) with tube & collimator

Power Requirements

- 110/240 Vac.
50/60 Hz, 700 VA

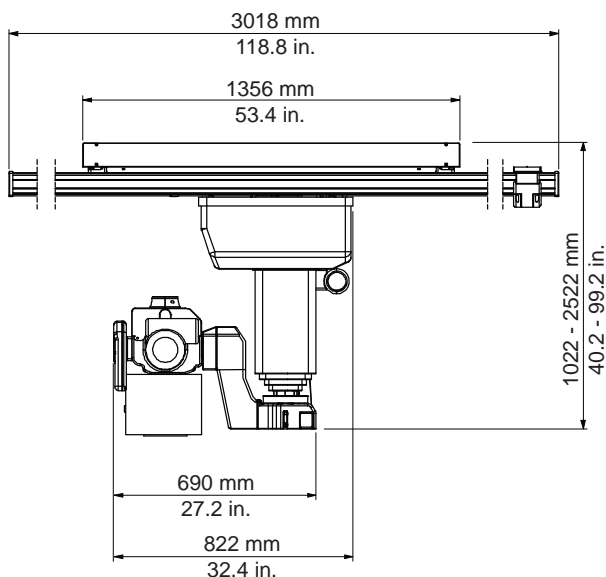

Del Medical is an ISO13485 & ISO9001 Certified Facility.
Complies with CDRH performance standards in effect at time of shipment. Specifications are subject to change without notice.
UL Classified. CE Marked.



U.S.A.
Del Medical Systems Group
50B North Gary Avenue
Roselle, IL 60172
Toll Free: 800-800-6006
Tel: 847-288-7000
Fax: 847-288-7011



EUROPE
Villa Sistemi Medicali
Via delle Azalee 3
20090 Buccinasco-MI-Italy
Tel: +39-02-48 85 91
Fax: +39-02-48 81 844